

**073106T4QSV**

**QUANTITY SURVEYING LEVEL 6**

**ENG/OS/QS/CC/04/6/A**

**Execute Construction Works**

**July/August 2025**



**TVET CURRICULUM DEVELOPMENT, ASSESSMENT AND CERTIFICATION  
COUNCIL (TVET CDACC)**

**PRACTICAL ASSESSMENT**

**Time: 6 HOURS**

**INSTRUCTIONS TO CANDIDATE:**

1. You are required to perform the following tasks
  - i. Set out the position of formwork for pad foundation in figure 01 measuring 600mm x 600mm x 100mm on a prepared surface.
  - ii. Cut, bend, and place reinforcement for the pad foundation and column.
  - iii. Mix, cast and compact concrete into the formwork for the pad foundation
  - iv. Assemble and fix formwork for the column (200mm x 200mm x 750mm high) as shown in figure 01
  - v. Provide support for column formwork
  - vi. Mix, cast and compact concrete into the formwork for the column
  - vii. Finish the top surface of the concrete
2. You have been provided with the following resources for the practical tasks:

- Measuring Tape (3m or 5m)
  - Spirit Level
  - Hammer
  - Shovels
  - Builder's square
  - Plumb bob
  - Cutting tool / pliers
  - Bending tool
  - Trowel and float
  - Wheelbarrow
  - Compaction rod
  - Nails 2''
  - Lime/cement
  - Reinforcement bars 6mm diameter
  - Binding wire
  - Sand
  - Ballast
  - Timber boards 25mm thick
  - Water
3. You may engage one non candidate assistant per candidate

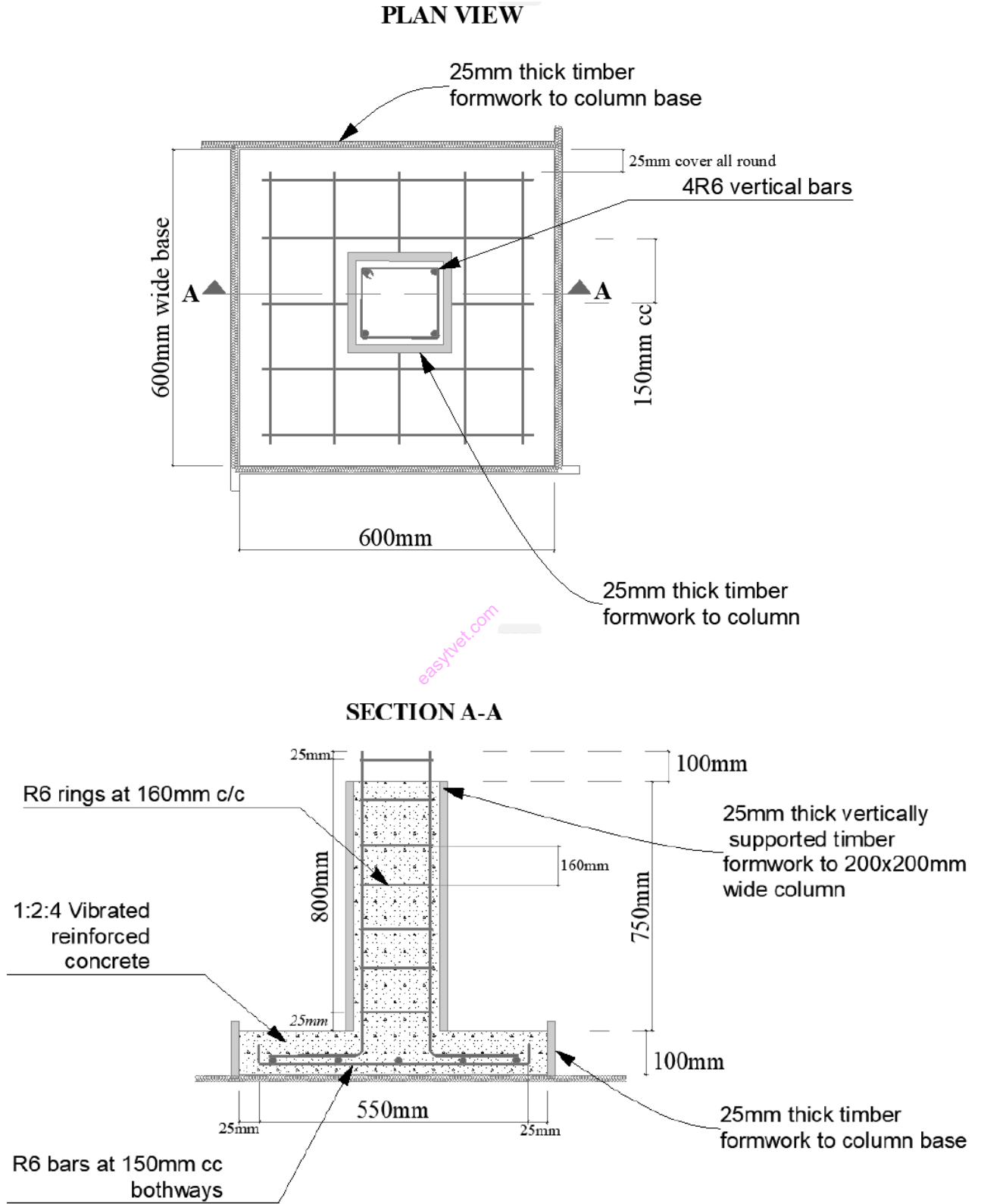

**Fig. 01**